



# The Bridge

February 2014

# Castle Care Wessex

*Because your home is your castle*



## **CARE IN YOUR OWN HOME**

We are a mother and daughter team running a professional, friendly agency specialising in:

### ***24 hour live-in care***

Helping loved ones stay in their own home, maintaining their independence, and

### ***Domicillary Care***

For short periods of time, perfect for clients who enjoy their independence but appreciate a helping hand.

For more information telephone 01373 836767  
email: [castlecarewessex@btconnect.com](mailto:castlecarewessex@btconnect.com)  
[www.castlecarewessex.com](http://www.castlecarewessex.com)



## *Whitehorse Auto Styling*

**0800 33 57 034**

**Unit 8, Cory Way, West Wilts Trading Estate, Westbury, Wilts, BA13 4QT**

Installers of:

**Hands-free phone kits**

**Parking sensors**

**Paint protection film and bumper kits**

**In-car TV/DVD screens**

**Lights, bars and beacons**

Westbury ~ 01373 824073

Mobile ~ 07976 931370

Salisbury ~ 01722 320777

email ~ [theautostyler@hotmail.co.uk](mailto:theautostyler@hotmail.co.uk)

# The Bridge

monthly magazine for the villages of Corsley and Chapmanslade

## Articles

Please submit articles either by email to [viv.thomas146@btinternet.com](mailto:viv.thomas146@btinternet.com) or by hand (legible handwriting please!) and take them to the drop-off locations at Barbers Plant Centre, Chapmanslade, or Acres Supply Garden Centre, Corsley by the deadline.

News, reports, updates, thank you's, etc, from individuals or local organisations are free – the more the merrier – keep 'em coming!

## File types

Save your files as .doc – please don't send .docx files – I can't always open them successfully.

## Advertising

**Small ads** are £1 for each item 'For Sale' or 'Wanted'.

**Events/local organisation ads** (churches, clubs, playgroups, etc) are £2 per month for a small, boxed advert.

**Larger ads** are subject to space availability and by arrangement with the Editor who will advise on the price.

If you are advertising, don't forget to take the fee – cash or cheque in a sealed envelope please, to either of the drop-off points (Barbers Plant Centre or Acres Supply).

**Please note: no cash, no advert!**

## Trade advertising

Please see the last page.

## In this issue...

**8 Bob's Bafflers**  
a cunning quiz

**16 Neighbourhood Watch**  
through the keyhole

**18 Parish Council briefing**  
Corsley

**Playing Field Update** **21**  
sporty spiel

**Three Open Doors** **23**  
news from the pews

**Corsley WI** **28**  
news from the ladies

**34 Parish Council briefing**  
Chapmanslade

**41 Whitbourne Chapel**  
chapel colloquy

**46 Countryside matters**  
views from over the hedge

## Deadline

**Deadline for articles  
or adverts for the next  
issue of The Bridge is  
4pm 19th February**

**Please note that no  
items will be accepted  
after this date**

---

## February

### Saturday 1st

Corsley litter pick – 10.00, meet opposite the Royal Oak

### Tuesday 4th

Coffee Morning – 10am - 12 noon, Corsley Reading Room

### Thursday 6th

Warminster mobile library (see page 48 for times)

Chapmanslade Loose Women - a talk on Frome Child Contact Centre – 7.30pm, 11 Brimhill Rise, Chapmanslade

### Saturday 8th

Chapmanslade Litter Pick – 12 noon, meet opposite The Three Horseshoes

### Monday 10th

Corsley Parish Council – Annual Parish Meeting – 7.30pm, Corsley Reading Room

### Thursday 13th

Corsley WI – 2.30pm, Corsley Reading Room – Keeping Hens in the Garden

Chapmanslade Parish Council meeting – 7.30pm, Chapmanslade School

### Friday 14th

Tea Party – 2.30 for 3pm, Chapmanslade Village Hall

### Wednesday 19th

Lite Bites Bread and Soup Lunch – 12.30pm, Corsley Reading Rooms

Corsley Gardening Club - a talk on Bougainvilleas – 2.30pm, Corsley Reading Room

Parochial Church Council – 7.30pm, Chapmanslade School

### Thursday 20th

Church and Community Coffee Morning – 10.00am - noon, The Three Horseshoes, Chapmanslade

Warminster mobile library (see page 48 for times)

### Wednesday 26th

Parochial Church Council – 7.30pm, Chapmanslade School

### Friday 28th

Pantomime - King Arthur and the Patio Table – 7.30pm, Chapmanslade Village Hall



*please note change of date (was the 26th)*

# Diary Dates

---

## March

### Saturday 1st

Corsley litter pick – 10.00, meet opposite the Royal Oak

Pantomime - King Arthur and the Patio Table – 2pm and 7.30pm, Chapmanslade Village Hall

### Tuesday 4th

Coffee Morning – 10am - 12 noon, Corsley Reading Room

### Thursday 6th

Warminster mobile library (see page 48 for times)

Warminster Area Board – 7.00pm, Warminster Civic Centre

### Saturday 8th

Chapmanslade Litter Pick – 12 noon, meet opposite The Three Horseshoes

Barn Dance – 7.30pm, Chapmanslade Village Hall

### Monday 10th

Corsley Annual Parish Meeting – 7.30pm, Corsley Reading Room

### Wednesday 12th

Lent Lunch – 12.30 - 2.00pm, Manor Farm, Corsley

Parochial Church Council – 7.30pm, St Margaret's

### Thursday 13th

Corsley WI – 2.30pm, Corsley Reading Room, Annual Meeting

Chapmanslade Parish Council meeting – 7.30pm, Chapmanslade School

### Friday 14th

Afternoon Tea – 2.30pm for 3pm, Chapmanslade Village Hall

### Wednesday 19th

Corsley Gardening Club - visit to Long Acre Plants, Wincanton – assemble there at 2.30pm

### Thursday 20th

Church and Community Coffee Morning – 10.00am - noon, The Three Horseshoes

Warminster mobile library (see page 48 for times)

### Friday 21st

Irish Night – 7.00 - 11.00pm, Corsley Reading Room

### Wednesday 26th

Lent Lunch – 12.30pm, Corsley Reading Rooms

### Friday 28th

Corsley Memorial Playing Field Fashion Show - M&Co Warminster

## Stuck in a rut?

# Good Neighbours

Join in with a wide range of social groups and activities set up just for older people in our area...



After the excitement and rush of Christmas and New Year, January and February can be dull and grey months and we can all feel a bit stuck in because of the cold and sometimes icy weather.

It seems apt therefore to draw your attention to some of the range of social groups and activities available for older people in the Warminster community area. There are many clubs and societies whatever your interests or abilities.

Sometimes it is hard to find out what is on and how to access these groups. It can also be daunting to turn up on your own for the first time or may be difficult to attend due to a lack of transport. As your local Good Neighbour Coordinator I can provide you, your friends or neighbours with the information on these groups and help to make taking that first step a little bit easier for you.

If you are not comfortable leaving your home or unable to, but would like some more social contact, there are several organisations who can offer a befriending service in the area, where someone could visit you every now and again for a chat or call you once a week on the telephone.

Perhaps you have some free time and feel you could volunteer to help reduce the social isolation in your local area. Many of the befriending organisations are always on

the look out for more volunteers.

If you think I could help you or you are interested in finding out more about anything mentioned above, please feel free to ring me and I will do what I can to provide you with the information that you need and put you in touch with the right people.

Wiltshire Good Neighbours is a free and confidential service, which provides information and signposts older residents living in the Warminster Rural Community Area to the excellent service and organisations that are available to them. Wiltshire Good Neighbours provides information about any and every service available to help older people live more independent and fulfilling lives.

Call me on 07557 922033 or email me at [warminstergnc@communityfirst.org.uk](mailto:warminstergnc@communityfirst.org.uk)

*Emma Curtis*  
*your local Good Neighbour Coordinator for*  
*Warminster Rural Community Area*



Quality care and support in Warminster and the surrounding villages



**We are a small, Corsley based care provider**  
**We provide care to people who need support to remain living in their own home**  
**Please telephone or email us, or visit our website for further details**

Tel. 01373 832597

[enquiries@cloudhomecare.co.uk](mailto:enquiries@cloudhomecare.co.uk)  
[www.cloudhomecare.co.uk](http://www.cloudhomecare.co.uk)



# Pears Electricians

Nigel Charteris - BSc (Hons) M.I.E.T.



## Professional Local Electrician

A HIGH STANDARD OF WORK AT REASONABLE RATES

Part P registered with [www.napit.org.uk](http://www.napit.org.uk) - Testimonials and references available

**Faults & Troubleshooting • Repairs & Improvements**  
**Installation Condition Reports • Boiler Wiring**

[www.pearselectrical.co.uk](http://www.pearselectrical.co.uk)

**01985 213314 or 07717 534026**



## OAKLEY

### GARDEN MACHINERY

Grove Lane, Marston Trading Estate  
 Frome, BA11 4AT

Hayter  
 Mountfield  
 Lawn King  
 Westwood  
 Stihl  
 Honda  
 Toro  
 Echo  
 Husqvarna  
 Shindalwa  
 Oregon  
 and more...



**For Sales, Spares,  
 Workshop Service  
 and Repairs**

[www.oakleyfrome.co.uk](http://www.oakleyfrome.co.uk)

**01373 467712**

## Bride by Design

**Bridal Gowns & Accessories**



2 Silver Street  
 Warminster  
 BA12 8PS

01985 217216

Please contact us to arrange an appointment  
[www.bridebydesign.biz](http://www.bridebydesign.biz)

## STUNNING COASTAL VIEWS ON CORNISH COAST NEAR LOOE



Six bedrooms (sleeps 12)  
 Private access onto beach  
 Pets allowed

Top class facilities including wi-fi  
 Rent for week or even long weekend  
 Downstairs bedroom and shower room

**For more info: Sandy Parrish 01373 832522**



## J DANCE

### PLUMBING AND HEATING

Flat 6, 49 Woodcock House  
 Woodcock Road, Warminster, Wilts

07767 743325

[d1172@hotmail.com](mailto:d1172@hotmail.com)

**McCulloch**  
FURNITURE

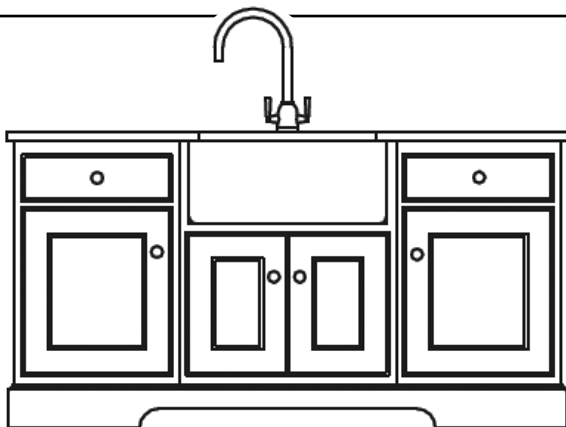

Kitchens • Bedrooms • Bathrooms • Libraries  
Studies • Media furniture • Offices • Freestanding

The Workshop, Bruton Lane, Upton Noble, Somerset, BA4 6AH  
Telephone 01749 850000 Fax 01749 850055 Mobile 07887 892633  
[enquiries@McCullochfurniture.co.uk](mailto:enquiries@McCullochfurniture.co.uk)  
[www.McCullochfurniture.co.uk](http://www.McCullochfurniture.co.uk)

## ORCHARD UPHOLSTERY

RE-UPHOLSTERY OF  
ANTIQUE AND MODERN  
FURNITURE

❖ FREE ESTIMATES ❖

COLLECTION AND  
DELIVERY SERVICE

Telephone Lesley  
01373 464870

## HASL

Hyde Accounting Services (AAT) Ltd  
Accountant and Bookkeeper

We specialise in working with small businesses  
to provide plain-speaking, focussed accountancy  
including Self Assessment tax, VAT, payroll and CIS



We can also advise new  
businesses with no prior  
accounting knowledge

**Vanessa M A Hyde MAAT**

The Forge, 104a Corsley Heath  
Warminster, Wiltshire, BA12 7PP

01373 832700, or 07740 468003  
[vanessa@hydeaccounting.co.uk](mailto:vanessa@hydeaccounting.co.uk)  
[www.hydeaccountingservices.co.uk](http://www.hydeaccountingservices.co.uk)



**‘Raine raine goe to Spain: faire weather come againe’**

# Corsley Rainfall 2013

The rainfall is read daily at ‘Hill Rising’, Corsley at 0900hrs in winter and 1000hrs in summer time. The measurements are forwarded at the end of each month to the Environment Agency (Southwest Region) and on to the Met Office. The Environment Agency uses the readings for flood defence operations and general water resource management. The Met Office uses them to record the climate of the UK for future generations.

## 2013 rainfall

January .....	101.1 mm
February .....	27.9 mm
March .....	60.1 mm
April .....	140.4 mm
May .....	60.4 mm
June .....	30.7 mm
July .....	49.9 mm
August .....	37.9 mm
September .....	58.4 mm
October .....	170.9 mm
November .....	77.0 mm
December .....	167.9 mm

**882.6 mm (34.8 inches)**

## Yearly rainfall

2008.....	918.5 mm
2009.....	826.8 mm
2010.....	649.4 mm
2011.....	677.6 mm
2012.....	1090.9 mm
2013.....	882.6 mm

## Average annual rainfall 2008 - 2013

841.0 mm (33.1 inches)

## Rainfall from 1st to 6th Jan 2014

98.2 mm (3.87 inches)

*Shirley Chapman*

*Volunteer Rainfall Observer for Corsley*

*01373 832378*

## Litter pickers

### Chapmanslade litter pickers

We will be meeting opposite the Three Horseshoes at noon on Saturday 11th January. We provide all the necessary equipment and spend about an hour or so collecting litter from the High Street and surrounding area.

*Phil Jefferson*  
01373 832845

### Corsley litter pickers

We meet opposite the Royal Oak at 10am on the first Saturday of each month. Our next ‘pick’ is on Saturday 1st February – do come along and help keep our village beautiful.

*Cath Aylesbury and Sue Taylor*

# Bob's bafflers

- 1 In which county is Eton School located?
- 2 Who was "feared by the bad and loved by the good"?
- 3 What was the most popular name given to boys born in 2013?
- 4 What name is given to the lowest layer of the atmosphere?
- 5 In London, where would you find Poet's Corner?
- 6 Which US State has Boston as its capital city?
- 7 If a mammal is described as ungulate, what does it have?
- 8 Which actress was jailed in 1982 for tax evasion?
- 9 Which gas propels the cork from a champagne bottle?
- 10 Who wrote the book "Chitty Chitty Bang Bang"?
- 11 In which film did John Wayne win his only Oscar?
- 12 In the war song "pack up your troubles" what do you need to light a fag?

Answers on page 48



## The Corsley Show 2014 The Special Class

With the temptations of the Christmas and New Year excesses behind us, it is the time to think about our hearts. The Horticulture and Craft Section of the Show will be raising funds for the British Heart Foundation with a Special Class...

### A Decorated Heart

There are no constraints on the design and decoration of the exhibits – they can be barmy or beautiful, but they **must** include a method of being hung on a rope so they can be judged by visitors to the Show. The winning exhibit will be the one that attracts the most money from the general public by 4.00pm on Show Day. All the money, including the entry fees, will go to the British Heart Foundation.

There will be a valuable prize for the winning entrant, so now is a good time to be thinking of your heart, both as a creative endeavour and as a matter of health.

# UPVC REPAIRS WILTSHIRE.CO.UK

FOR PROFESSIONAL WINDOW & DOOR REPAIRS

Are you having a problem with your UPVC windows or doors?

- ✓ Misted glass
- ✓ Broken or faulty window hinges
- ✓ Faulty locks
- ✓ Jammed windows or doors
- ✓ UPVC door adjustments
- ✓ Window and door handles

Call us – we are here to help

All work guaranteed

01373 430010 07795 143228 [www.upvcrepairswiltshire.co.uk](http://www.upvcrepairswiltshire.co.uk)

## the three horseshoes

The pub Chapmanslade deserves

Open daily from 10am-11pm serving delicious home cooked food (12-3pm & 6-10pm Mon - Sat. All day Sun.) Enjoy a refreshing drink in our beer garden with spectacular views of Longleat and Cley Hill or indulge with one of our regular meals deals by the warm, open fire on a bitter winter's day. We organise monthly events featuring live music, comedy and much more!

Call us on 01373 832 211

Follow us on Facebook for more details.



threehorseshoeschapmanslade



### Clare Merritt

*Quality upholstery and loose covers*

*Curtain make up and poles*

*Fabrics supplied · Carpets supplied/fitted*

*Blinds made to measure*

01373 464993

Established 1973

### Piano Tuition

*All standards welcome*

**Debbie Rickhuss LLCM BEd**

Teacher Pianoforte and Theory

*reasonable rates ~ 01373 832829*



**Shake off those pounds and  
dance yourself fit.**

Chapmanslade Village Hall  
Monday 7.30pm - 8.30pm

Longbridge Deverill Village Hall  
Tuesday 6.30pm-7.30pm

For all levels of fitness and  
NO experience needed.

For more information please contact  
Odele 07860 472894

## Busy Bees Pre-School Chapmanslade

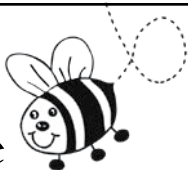

For children aged 2 - 5 years  
Monday to Friday 9am - 3pm

Please contact Kelly Williams to arrange a  
visit and a free trial session for your child

After-school Club open 3.15pm-6pm, 5 days  
a week – term time only

Telephone 07749 257608  
busybeespre-school@hotmail.co.uk

## FENCING



### **Garden Fence Company** *Garden fencing supplied and erected*

- Repairs to existing fences
- Old fencing removed from site
- Hedges cut
- Small trees felled

*For a friendly, cost effective and reliable  
service contact Gerald Gasgoigne on:*

**07506 373335, 01373 832613**  
**info@wessexgardenfencing.co.uk**  
**www.wessexgardenfencing.co.uk**

## WEST COUNTRY SWEEP

Domestic & Commercial Chimney Services

Andrew Leigh

07545 822109

westcountrysweep@gmail.com



For your  
Heating Oil Supplies  
contact

## KINCH FUELS

at their  
local depot in  
Devizes, Wiltshire

Telephone 01380 727102

*The company you and  
your home will warm to*



### LUXURY PRIVATE CAR HIRE

A locally based, door-to-door, personal  
service for up to six passengers in  
air conditioned comfort

AIRPORTS • SEAPORTS • ANYWHERE

For bookings, please call  
01985 840088 07903 307734

# Corsley Gardening Club

Forthcoming events...



## February 19th

Talk on Bougainvilleas  
2.30pm at the Reading Room

## March 19th

Visit to Long Acre Plants, Wincanton  
Assemble there at 2.30pm



## April 16th

Wells Cathedral Gardens  
Assemble there at 2.30pm

## May 21st

Visit to Westdale Park to see the  
Bougainvilleas  
Assemble there at 2.30pm

For further details please contact  
**Pauline Scott** on 01985 215760

## *Calling all Senior Citizens*

*Come to tea  
Chapmanslade Village Hall  
Friday, 14th March  
2.30 pm for 3 pm  
and make new friends!*



*Put it in your diaries now!*

## **Corsley Parish Council ANNUAL PARISH MEETING**

**Monday 10th March at 7.30pm at the Corsley Reading Rooms**

**Presentation and discussion on Neighbourhood Planning  
and its potential opportunities**

(guest speaker from Wiltshire Council Planning Department)

How do you want to see Corsley develop?  
Do you want more housing or less housing?  
What is most important to you about Corsley?  
Do you want any change at all?

followed by the  
**Parish Council Annual Report**  
presented by the Chairman, Neil Britten



For Expert Tree Care

Telephone Jon Burgess on

**01985 214320**

Skilled pruning

Tree felling

Stump removal

Qualified and insured

**Free tree health  
survey and quotes**

*Keep active with physiotherapy*

**Alison Rossiter MCSP HPC**

**Chartered Physiotherapist**

30 years experience in physiotherapy specialising in the treatment of muscle and joint problems.

Helping people to improve their health and fitness through treatment, exercise and advice.

Home visits can be arranged.

Daytime and evening appointments available.

*If you need help please contact:*

**Beckington Physiotherapy 01373 831483**

**Email: arossiterphysio@gmail.com**

**www.beckingtonphysio.co.uk**

**DAVID EDMUNDS & CO**  
ACCOUNTANTS & TAX CONSULTANTS

*Specialists in the self-employed, small and medium business and self assessment.*

*Preparation of accounts, VAT, PAYE, income tax and corporation tax returns.*

*Personal, friendly service*

*Evening appointments by arrangement*

Telephone 01225 334447

Home 01373 832430



**Dog walks and  
holiday pet care**

01985 988268

07878 754987

[www.wiltshirepetcare.com](http://www.wiltshirepetcare.com)

**PAINT & PASTE**

*Quality with reliability always*

**Martin Bendle**  
Painter & Decorator

7 Willoughby Close  
Westbury, Wiltshire  
BA13 3GA

**07741 492617**

[martin.paintandpaste@gmail.com](mailto:martin.paintandpaste@gmail.com)



*The Chapmanslade Players*

INVITE YOU TO A  
PANTOMIME...

◆  
*King Arthur  
and the Watio Table*  
◆

FRIDAY 28TH FEBRUARY AT 7.30PM  
&  
SATURDAY 1ST MARCH AT 2PM AND 7.30PM  
CHAPMANSLADE VILLAGE HALL

◆  
BAR AND  
REFRESHMENTS  
◆

TICKETS £5 FOR ADULTS AND £3 FOR CHILDREN  
FROM KEN (01373 832034) OR PTA (01373 832080)

# ALLSOP CARPETS & FLOORING

DOMESTIC ♦ COMMERCIAL ♦ INDUSTRIAL

Christchurch Street West, Frome BA11 1EB

TEL: 01373 463866 MOBILE: 07887 953014

[www.allsopcarpets.co.uk](http://www.allsopcarpets.co.uk)

## Chapmanslade Village Hall

Can be hired for all your functions:  
parties, weddings, meetings, classes, etc

For hiring information, phone  
Ken Davies 01373 832034 or email  
[chapmansladehall@blueyonder.co.uk](mailto:chapmansladehall@blueyonder.co.uk)

## KEYVOLUTION

Locksmith and  
Carpentry Services  
serving the Wiltshire Area

Warminster based company offering locksmith and carpentry.  
Police cleared, reliable and honest service.

Any other quote beaten.

- BS3621 lock upgrades for house insurance approval
- Garage doors, locks and running gear
- Lock repairs – specialising in Chubb mortice locks
- Upvc double-glazed door and window locks fitted – even old ones!
- Door or window locks opened destructively or non-destructively (indemnity required for these services)
- Digital code locks supplied and fitted
- All types of carpentry work – mostly 2nd fix and maintenance

Check out my website

[www.keyvolution.co.uk](http://www.keyvolution.co.uk)



or call Ben on 07748 214799 or 01985 219799



**Housemaids**  
**Domestic services**  
Est 1988  
Weekly cleaning  
Holiday lets  
Spring cleaning  
Commercial cleaning  
For more information call  
**01373 474246**

## White Horse Windows

Windows, Doors, Conservatories and  
more...

Local Company, Exceptional Standards  
10 year guarantee

Windows Fascia & Guttering  
Doors Conservatories

CERTASS Registered

For a Free Quotation call Ryan on  
**07909 441442 or 01373 302594**

## Kevin O'Mahony

Quality Painter and Decorator

Internal and external painting

Artexing

Wallpapering

Coving

Hand painted kitchen units

07724 349447 or 01985 301197

email [kevo7743@googlemail.com](mailto:kevo7743@googlemail.com)

[www.thewarminsterpainter.co.uk](http://www.thewarminsterpainter.co.uk)



# BARTERS PLANT CENTRE

‘Passionate about Plants’

Shrubs ♦ Perennials ♦ Trees ♦ Roses ♦ Conifers  
Climbers ♦ Fruit Trees ♦ Hedging ♦ Soft Fruit ♦ Seeds  
Bulbs ♦ Basket Plants ♦ Bedding ♦ Vegetable Plants  
Christmas Trees ♦ Holly Wreaths  
National Garden Gift Tokens



**Opening Hours**  
Summer: Mon-Thur 9.00 - 5.00, Fri & Sat 9.00 - 5.30  
Winter: Mon-Thur 9.00 - 4.30, Fri & Sat 9.00 - 5.00  
Sundays: 10.00 - 4.00  
Just off A36 in Chapmanslade, Wilts, BA13 4AL  
Tel: 01373 832694 [www.barters.co.uk](http://www.barters.co.uk)



## JONATHAN CORP

Painter and Decorator  
General House Maintenance  
Sturford Mead Farm, Corsley  
Warminster, Wiltshire, BA12 7QU  
01373 832213

## Postlebury News R Gould – Newsagent

All papers and magazines  
Home delivery service

01749 850556 07979 452677



## *T A P Services*

*Telephone/Fax 01373 463106*

*[www.tapservices.co.uk](http://www.tapservices.co.uk)*

*Authorised Stanley Service Agent*

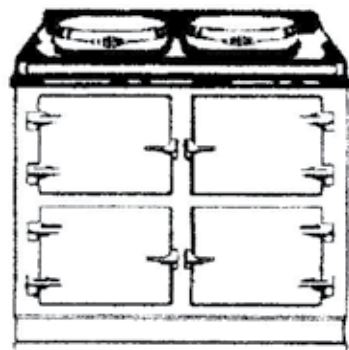

# *Range Cooker Servicing*

## Through the keyhole

# Neighbourhood Watch

Following an audacious theft in Corsley – Mike Bird urges us to have our houses and contents properly insured

Recently I heard of another audacious theft of property arising from break-in to private property in Corsley. It would seem in this instance the property stolen had been selected prior to the theft taking place. This has made me think about House and Property Insurance particularly relating to theft. Are you one of those people who find it a chore each year when the renewal comes about? You instinctively know your premium is likely to increase even without a claim in the preceding year. The insurer has indexed linked your sums insured by the cost of living or some other number that they want to put to you. Do you look at the sums you have insured and think to yourself “ That’s about right” and move on to the premium? When did you last sit down and list what you own, and then apply today’s replacement value for those items. You might be surprised by the sums once you have completed the task. Have you read your policy document carefully? Do you know what important information and changes were made last year when you renewed your policy? Did you read the document and understand it? Do you know what your policy excess is? Do you know what your Personal Belongings Limit is? Is it correct? Have you got what your insurer has stipulated as minimum security to your property?

When you renew your policy this year, sit down with a cup of coffee and read what

you have been sent. Ensure you have correct sums insured – have you missed anything of value you believe should be covered. If you are not sure about any detail relating to the wording of your policy document, do not feel embarrassed to ring your insurer’s Customer Service section and ask them. Then at least if you are unlucky enough to suffer a theft you can be sure that your claim will be met without a great deal of hassle and heartache by your insurer.

Finally, our PCSO Elizabeth Harmsworth has supplied some really useful information regarding on-line registration of property...

Immobilise ([www.immobilise.com](http://www.immobilise.com)) is the world’s largest FREE register of possession ownership details and is a very effective tool for helping repatriate recovered property to its rightful owners. Used by both members of the public and businesses to register their valued possessions or assets, its the only ownership registration service used and supported by all UK Police forces and the mobile phone industry. The online tracking service is also checked daily by a range of recovery agencies and lost property offices. Visit their website for more information.

I’ve had a look at the website to see what it offers. It seems interesting but I do not know anyone who has used it yet. Let me know if you have.

*Mike Bird*  
Corsley Neighbourhood Watch Coordinator

# Lent Lunches 2014

12.30 – 2.00pm



**Wednesday 12th March**

Manor Farm Corsley

by kind permission of Chris and Claire da Costa

**Wednesday 26th March**

Corsley Reading Room

**Wednesday 9th April**

Black Dog Farm Chapmanslade

by kind permission of Fraser and Lyn Mills

Do come along and join us – and tell your friends and neighbours!

Stranger things happen at sea...

The Elizabethan Evening goes overboard in 2014.  
Saturday 2nd August, Manor Farm, Corsley

## **"THE PIRATES OF PENZANCE"**

by Gilbert and Sullivan

Performed by the Illyria open air theatre  
company.

**PLEASE NOTE THE CHANGE OF DATE**

Rum doing m'hearties, rum indeed. We got in  
a bit of pickle in a cod barrel about the dates  
so please note the correct one is

**2nd August.** Same place, same time and all  
the same superlative entertainment.

You'll still be guaranteed an evening like  
no other – and that's a promise.

So be first to contact me good lady Claire  
with your ticket and supper orders on  
01373 832113 and tell her Sally sent you.

Yours in perpetual confusion,  
Cap'n Sally Forths

An evening of  
traditional Irish music  
and dancing  
Featuring SHEBEEN



Friday 21st March  
Corsley Reading Room

7.00pm — 11.00pm

Traditional Irish Supper (+  
vegetarian option) and Bar

Tickets £12.50

Tickets available from Jean Jones 01373  
832189 and Committee Members

**Corsley Parish Council**

# Parish Council Briefing

The Chairman reports on the latest activities of the Committee

December has been fairly quiet on the PC front and this is a very short article. Although there have been no full PC meetings since the last Bridge, delegated members of the PC held two, one with Little Cuckoos to finalise the lease for their use of the Old School Playing Field (OSPF), the second with the Caravan Club and Longleat staff to further the discussions on caravan traffic through Lane End.

The lease with Little Cuckoos is now a new direct agreement with the PC for their continued use of the OSPF for the Pre-School building, adjacent parking and the playing field itself, for a five year period, with an agreed suitable annual fee. The new lease replaces the previous one with Wiltshire, with whom the PC now has a long lease for the whole of the OSPF area.

A third meeting took place on 3rd January to discuss the caravan traffic through Lane End. This time the Caravan Club came along and several options were tabled in an attempt to identify one which might reasonably achieve the objective of, at the very least, one way caravan traffic through Lane End. The underlying intent is to reduce the risk of collision at the A362 junction and other critical points in the present route, lessen the likelihood of log-jams and damage to private property and, most of all, increase safety.

The options carried varying degrees of benefit, but were generally outweighed by considerations of cost and complication

of intensified traffic flows inside Longleat grounds. However, one was proposed by Longleat which merited further consideration. This will now be discussed with Wiltshire at a further meeting on 24th January and the outcome will be reported to the PC for their full consideration.

Last month I wrote about the developing plans for the Annual Parish Meeting (APM). Page 11 of this edition of The Bridge features an advert publicising the event – we are very pleased to have a professional speaker on the subject of Neighbourhood Planning. Please put the date, **10th March**, in your diaries as the main concern is to get a village view on the opportunities that a Neighbourhood Plan might offer. At the APM I will also give the Chairman's Annual Report of PC business over the last year.

On a final note, we have all suffered in varying degrees from the dreadful weather over the last three weeks and the consequences for the lanes around Corsley. I must wholeheartedly thank all those hardy souls who repeatedly turned out in awful conditions over the Christmas period to relieve the several unwanted 'lakes' that routinely appeared in key points. The PC is very aware of these areas and they will be high on the agenda of our next meeting with our Community Area Co-ordinator.

Neil Britten  
Chairman, Corsley Parish Council  
[neil.britten@btinternet.com](mailto:neil.britten@btinternet.com)

# Chapmanslade: recycling, garden waste and household waste collection calendar

## January – March

Remember to put them out by 7am on collection day. Ensure the lid is closed and do not leave any household waste next to the bin for collection.

### Black bin

#### January

Thursday 9th  
Wednesday 22nd

#### February

Wednesday 5th  
Wednesday 19th

#### March

Wednesday 5th  
Wednesday 19th

### Green bin

#### January

Thursday 9th  
Wednesday 22nd

#### February

Wednesday 5th  
Wednesday 19th

#### March

Wednesday 5th  
Wednesday 19th

### Blue bin

#### January

Friday 3rd  
Wednesday 15th  
Wednesday 29th

#### February

Wednesday 12th  
Wednesday 26th

#### March

Wednesday 12th  
Wednesday 26th

### Black box

#### January

Saturday 11th  
Friday 24th

#### February

Friday 7th  
Friday 21st

#### March

Friday 7th  
Friday 21st



# Clean-it

Recommended by



Carpet and upholstery cleaning specialist

**01373 462059 or 07779 247961**

Home ~ Private ~ Lettings



**TRAVELSTAR UK**

*Luxury chauffeured travel since 2002*

Mercedes 'S' Class and 'E' Class cars

all in immaculate silver with

air-conditioned / leather interiors

Classic Bentley wedding day cars

8-seater people carriers



**info@TravelstarUK.com**

**01373 430501**

**www.TravelstarUK.com** "A pedigree local service"

## Longleat Forestry

*Picket Post, Warminster  
Wiltshire, BA12 7JS*

firewood logs

coal

kindling

woodchip

mulch

rustic poles

firelighters

christmas trees

**01985 213507**

Domestic Appliance Spares and Repair Service

## Domesticare

Mike, David and Sue Wye

21 Keyford, Frome

**01373 467351**

## Professional Childcare

Qualified, approved and registered.

A tailor-made, personal service.

Local and surrounding areas.

Call 07883 025476

[denise.m.rawlings@mypostoffice.co.uk](mailto:denise.m.rawlings@mypostoffice.co.uk)

## FURNITURE RESTORATION

Tables, chairs, bureau, chests,

long case clocks, mirrors, etc.

Veneer repair, polishing and waxing.

**Mr Lovatt 01225 764206 or 07709 687137**

Collection and delivery service

**JERRY RAYNER** ●  
boiler maintenance ●

**01985 841461 or 07775 755981**

**FOR SERVICING AND BREAKDOWN**

**OF OIL BOILERS**

*also AGA and RAYBURN*

- Competitive rates
- Friendly, helpful and efficient
- Call now for a quote

## Corsley Memorial Playing Field

# Playing Field update

Marion Liquorice gives us a run-down of recent and future events...

### What a great success the Spooky Dooos were!

The first Doo was at the playing field for the younger villagers, though plenty of the older ones had much fun too, with fancy dress, games, barbecue and prizes. Funded by a lottery grant we were able to give pumpkins and carving sets to the children so they could bring their handiwork on the night. How amazing they were, looking spectacular in the dark. Go to the Corsley and the Bridge website for some pictures [www.corsleyandthebridge.co.uk/Clubs.html](http://www.corsleyandthebridge.co.uk/Clubs.html) The pumpkin-based food fest at the Reading room was also great fun, bedecked with decorations and pumpkins from Doo 1, Spooky Doo 2 was a three course dinner and incorporated the Corsley Cricket Club presentation evening.

Looking forward to our next fundraiser it will be the third time that Sabine from M&Co in Warminster has hosted a fashion show for us, and great fun they are too, with our own models strutting their stuff rather brilliantly on the catwalk. **WE NEED SOME MODELS FOR THE M&Co FASHION SHOW ON 28 MARCH.** The winter will be long gone, the spring bulbs beginning to flower and so what could be better than the opportunity to enjoy the fashion show and browse the store with a discount voucher, in search of an outfit for summer?

### Facebook

We have set up a Facebook account! Find us at 'Corsley Memorial Playing Field'.

### WWI Memorial

As the playing field was created as a memorial to those who lost their lives in the World Wars, we would like to hold an event in this centenary of the start of the first war and would welcome suggestions from villagers as to what format this could take?

Please contact  
Marion at [marion@nmc2.co.uk](mailto:marion@nmc2.co.uk) and  
01373 832314, or  
Barbara 01373 832273, or  
Dot 01373 832059

## Chapmanslade Loose Women

Next meeting **6th February**, 7.30pm at Jackie Lobley's – 11 Brimhill Rise.

A talk by Jenny Ayrton on work done by volunteers for Frome Child Contact Centre.

*All welcome*



# Sharon's Foot Clinic

SAC Dip FHPT SAC Dip FHPP



*Fully insured and highly trained*

For the professional treatment of:  
Corns · Callus · Cracked Heels  
Athletes Foot · Fungal Infections  
Thickened Nails · In-growing Nails  
Diabetic Foot Care · Verrucas  
Nail Cutting · Nail Reconstruction

Contact Sharon on  
**01373 836734 or 07728 200402**

*Clinic appointments at*  
**12 Sunny Hill, Nunney, BA11 4ND**

Home visits also available

# Cross Keys

Lyes Green, Corsley

*Home-cooked food*

*12 - 2.30pm and 6 - 9pm*

*Open all day on Sundays*  
*food served 12 - 8pm*

*Function room and large beer garden*



**01373 832406**

[www.facebook.com/CrossKeysInnCorsley](http://www.facebook.com/CrossKeysInnCorsley)

# Corsley Tennis Club



New members welcome –  
all ages, all abilities

Three hard courts available all year

Weekly junior coaching available

Low subscriptions

Contact either

Jenny Bishop 01373 832834 or

Sue Newell 01373 825560



# Little Cuckoo's Pre-School

Lyes Green, Corsley  
(next to the Corsley Centre)

For children aged 2-5 years

Monday, Wednesday, Thursday and  
Friday – 9am – 3pm

Now accepting 2 year-old funding in  
accordance with Wiltshire Council guidelines

Mother and Baby Group  
Tuesday mornings from 10am to 11.30am

Contact Hayley McMahon 01373 832298  
[www.littlecuckoos@hotmail.co.uk](mailto:www.littlecuckoos@hotmail.co.uk)



CHRIS SEVIOUR  
Building Services

07894 708949

[cmseviour@gmail.com](mailto:cmseviour@gmail.com)

Roofing, Loft conversions,  
Extensions, Plastering,  
Natural stonework



# S B Services



Contact Sean

07828 671566

*For your garden maintenance  
and home improvements*



# Three Open Doors

## A time of change:

Following Norma's retirement as our Rector in September, the two Parochial Church Councils in the Benefice have been working very hard to reach the stage of advertising for our new Priest. The retirement of a Priest always provides an opportunity to review the needs of the Parishes, and following lengthy discussions in the Benefice, it has now been agreed that we will proceed to recruit a Priest to look after the two Parishes without any boundary changes. It should be borne in mind, that like any organisation, changes may evolve over time but not at present.

We have prepared a detailed Profile of the Benefice which describes the area, our Churches, and contains the job description. The position will be advertised in the Church Times in February with interviews taking place in March. Bearing in mind that any successful applicant will be required to give the appropriate period of notice to their existing Parish, the earliest that we might welcome a new Priest is July.

This allows us to look forward to the next phase of development in our Parish. It is quite clear that the provision of clergy diminishes throughout the Church of England and that the lay side must take a greater role in the spiritual life of the Church in our Parish. Many of our church members already have a very active role in planning our services and taking part in them, for example reading lessons and prayers. More recently we have re-invigorated the arrangements for providing pastoral support in the Parish. We look forward to developing this partnership with our new Priest who will be able to enjoy the benefits of an excellent support base from which to reach out to all in the community.

Phil and Keith

# February Church Diary

**Sunday 2nd February: Presentation of Christ**

9.30am at St Margaret's, Corsley

Eucharist



**Monday 3rd February**

10.30am at 5 Brimhill Rise, Chapmanslade

Time to Think Home Group – contact Phil 832845



**Tuesday 4th February**

7.30pm at 129d Forest Walk, Chapmanslade

After Alpha Home group – contact Richard 832594



**Sunday 9th February: Fourth Sunday before Lent**

9.30am at St Philip & St James', Chapmanslade

Family Eucharist

11am at St Mary's, Temple

Matins



**Sunday 16th February: Third Sunday before Lent**

9.30am at St Philip & St James', Chapmanslade

Eucharist



**Thursday 20th February**

10am to 12pm at the Three Horseshoes, Chapmanslade

Church and Community Coffee Morning



**Sunday 23rd February: Second Sunday before Lent**

9am at St Mary's, Temple

Holy Communion 1662

10.30am at St Margaret's, Corsley

Family Parish Worship

**Monday 24th February**  
10.30am at 116 High Street  
Time to Think Home Group – contact Phil 832845



**Tuesday 25th February**  
7.30pm at The Anchorage  
After Alpha Home group – contact Richard on 832594



**Wednesday 26th February**  
From 12.30pm to 1.30pm at Corsley Reading Rooms  
Light Bites Bread and Soup Lunch  
7.30pm at Chapmanslade School  
Parochial Church Council



**Sunday 2nd March: Sunday before Lent**  
9.30am at St Margaret's, Corsley  
Eucharist

### **Lent Activities**

An interesting programme of activities for Lent has been arranged.  
Full details will be announced in next month's Bridge.

### **Lent Lunches**

Please note these dates for your diary.

Wednesday 12th March at Manor Farm, Corsley

Wednesday 26th March at Corsley Reading Rooms

Wednesday 9th April at Black Dog Farm, Chapmanslade

The lunches will be from 12.30pm to 2pm and everyone is welcome.

Associate Priest	Rev Di Britten (day off is Friday)	01373 832515
Parish Office	Dick Collins (Cley Hill Villages Benefice)	01985 215460
Lay Pastoral Assistants	Richard Dean	01373 832594
	Barbara Hughes	01373 832273
	Claire Tanner	01985 218099
Churchwarden	Charles Thackway	01373 832048
Deputy Churchwarden	St Philip & St James – Janet Aylesbury	01373 832752
Deputy Churchwarden	St Margaret's – Judith Helliar	01373 832803
Deputy Churchwarden	St Mary's – Harcourt Gough	01373 832039
PCC Secretary	Phil Jefferson	01373 832845
PCC Minute Secretary	Sue Fear	01373 832074
PCC Treasurer	Keith Muston	01373 832755
Planned Giving Officer	Judith Helliar	01373 832803
Tower Captain	Dick Collins	01373 832789

## Church Notes

### Future dates for your diary

The Annual Parochial Church Meeting will be held on Wednesday 30th April at St Margaret's, Corsley.

The Spring Fayre and Table-top Sale will be held on Saturday 17th May at Chapmanslade Village Hall.

### 50/50 Club

As a method of raising much needed funds for maintaining our churches we run a 50/50 Club. You can join for a membership of £24 per year and you may have multiple membership if you wish. Twice a year we have prize draws and we return 50% of the membership fees to members. At present we distribute one prize of £200, two prizes of £100, three prizes of £50 and four prizes of £25 twice a year. The prize draws are usually held in May at the May Fayre and at the Christmas Coffee Morning in December. All prizes are in cash. The more members in the 50/50 Club the larger the prize pot!

To join our 50/50 club and be in the running to win please contact Neil Britten on 832515 or e-mail Neil on [neil.britten@btinternet.com](mailto:neil.britten@btinternet.com).

Copy for 3 Open Doors should be sent to Keith Muston at [themustons@btinternet.com](mailto:themustons@btinternet.com) subject 3ODs or phone 01373 832755.

If you would like to receive weekly news of Church events and activities, please send your email address to the above, with subject 'Through the Open Doors'.



*Individually tailored holidays  
for the very best in African travel*

J&C Voyageurs organises individually tailored African holidays for those looking for something special, memorable and away from the crowds. We will incorporate your distinct wishes and aspirations, with no detail overlooked, so that you are able to relax completely.

We have a passion for Africa and conservation of its wildlife, peoples and incomparable scenery. With over 20 years' experience exploring Africa and putting outstanding African holidays together, we can discuss hundreds of safari lodges, camps, beaches and city hotels with first-hand knowledge.

Telephone 01373 832111

Email [mail@jandcvoyageurs.com](mailto:mail@jandcvoyageurs.com)

[www.jandcvoyageurs.com](http://www.jandcvoyageurs.com)



## HolidaysNearLongleat.co.uk

A Dedicated website for;

Self Catering, Bed & Breakfast

Guest House, Camping & Caravanning

Accommodation all close to the Longleat Estate

## npv plumbing & heating

Installation • Servicing • Repairs

Bathroom and tiling specialists

All plumbing and heating work undertaken

Our fully qualified plumbers offer all general plumbing services from boilers to bathrooms. We will gladly advise clients on the most suitable products for their property – be it heating systems, boilers, radiators, bathrooms or showers.

07738 940355

[www.plumbersfrome.co.uk](http://www.plumbersfrome.co.uk)

## Hypnotherapy

If you need help with:

Anxiety

Depression

Phobias (such as flying or spiders)

Panic attacks

Relaxation

Weight management

Smoking cessation

Natural childbirth

Confidence

Public speaking

Exam nerves

and much, much more...

Call ANJI HOLLAND on  
07944 647 978 / 01373 832 898  
to enquire or just for a chat

[www.hollandhypnotherapy.com](http://www.hollandhypnotherapy.com)

With practices in Chapmanslade and Bath

I am a member of the National Council for Hypnotherapists  
and am bound by their code of practice and ethics

# Corsley WI

## January News



Carol Seward rounds up the meeting held on the 9th January and announces some forthcoming events

In the absence of Carol Seward, the Vice President Jean White welcomed members to a Lebanese Cookery evening at the January 2014 meeting of Corsley WI. Jean went swiftly through the business section of the meeting, with Di Dowling reporting on the recent visit by members to hear talks from the Lord Lieutenant of Wiltshire, Sarah Troughton, who oversees visits to the county by the Royal Family; and the Royal Biographer, Ingrid Seward, Editor-in-Chief of "Majesty" magazine, who talked about a century of Royal Children.

Jean then introduced Wafaa Powell to talk about and demonstrate Lebanese Cookery. Wafaa started by giving a background of the country of Lebanon and showed several posters of the country's scenery. After preparing a dish for cooking, she then enlisted the help of members to assist with chopping ingredients for the salad dish. Wafaa kept everyone interested showing posters of the different types of food eaten in Lebanon and there was much banter with the volunteers who showed their skills in cutting the vegetables to the specified size. With such an amusing commentary the cooked dish was soon ready and it

was time to sample the dishes. Members enjoyed trying out the Fattouch, Chicken with Bulgur Wheat and the Yogurt Salad and the sociable occasion completed a very enjoyable afternoon. Cath Fricker gave the vote of thanks.

Various Wiltshire Federation trips and events are being organized for 2014 and details were made available to members.

Our own annual outing is to **Highclere Castle** on **Monday 28 July 2014**; members are urged to book their seats early.

If you would like to join our WI and take part in any of these activities, you would be made very welcome. The lower age limit is 18 but we hope that our meetings are enjoyable for members of all ages.

Our next meeting is in the Reading Room, Corsley on **13 February 2014** at 2.30pm when Charlotte Popescu will tell us about "Keeping Hens in the Garden".

The competition is for an Egg Cup. Members are reminded also to bring their entries for the Hilda Guy Arts & Crafts Competition, which is for an Egg Cosy!

### **The following events held in the Reading Room in Corsley are open to anyone over 18, so why not join us?**

Coffee Morning      First Tuesday each month, 10-12noon

Gardening Club      Third Wednesday each month, 2.30pm

Bridge Club      First and third Tuesdays each month, 2-4pm

More details on the Gardening Club and Bridge Club from Pauline on 01985 215760

*Hold a Fish and Chip Supper to help spinal cord injured people rebuild lives after injury*



# Great British Fish and Chip Supper – Friday 16th May

Want to eat Fish and Chips, while raising money for charity? Hold a fish and chip supper on Friday 16th May 2014 whilst raising awareness of spinal cord injury and supporting SIA's vital services.

You can hold a fish and chip supper in your own home, at work or hold a larger supper at your local community centre.

SIA will provide a fundraising pack containing hints and tips, recipes, invitations and donation envelopes. By inviting 8 friends and asking them to donate an additional £5.00 means you will raise at least £40.00 from your supper but we will also give you additional fundraising ideas to raise even more money for SIA.

In 2014 SIA is celebrating its 40th anniversary and so we want to make the better matter and raise £25,000 from everyone holding suppers. Last year we raised £12,500 from the suppers.

The money raised from the suppers will help the Spinal Injuries Association offer support to individuals who become paralysed and

their families, from the moment a spinal injury occurs, and for the rest of their lives

by providing services and publications which enable and encourage paralysed people to rebuild lives after spinal cord injury.

Every year in the UK over 1,000 people experience a spinal cord injury and there are an estimated 40,000 spinal cord injured people in the UK alone.

Community Fundraising Manager, Elizabeth Wright, says, "The Fish and Chip Supper is a wonderful opportunity for a great evening with friends and family. We are also encouraging people who work to hold a Fish and Chip Lunch in their work places to raise even more funds. You may be even a local community group wanting to run a fun evening with your group.

For more information or request a fundraising pack call Elizabeth Wright on 0845 0714350, or email [fundraising@siafishandchips.co.uk](mailto:fundraising@siafishandchips.co.uk) or visit [www.siafishandchips.co.uk](http://www.siafishandchips.co.uk)

# Chapmanslade Motor Services

**Vehicle repair  
and servicing**

**Brake  
specialist**

**MOT preparation  
and repairs**



**Batteries  
Exhausts  
Tyres**



*Quality service at competitive rates*

**FREE** ~ wheel balancing and tracking with new tyres

**FREE** ~ courtesy car

Electronic diagnostics available – most makes covered

Green Farm Industrial Estate, Chapmanslade

01373 832188 or 07711 256927

**Busy  
Bees**



**01373 455911**

**SPECIALISTS IN CLEANING & GARDEN MAINTENANCE**

## **Our services include:**

- Domestic cleaning
- Commercial cleaning
- Carpet/Upholstery cleaning
- One off spring cleans
- Rental Cleaning
- Garden Maintenance
- Trauma Cleaning
- Builders Clean



Amy: 07971 921651 or Caron: 07971 921617

E-mail: [info@busybees2000.co.uk](mailto:info@busybees2000.co.uk)

[www.buzzybees2000.co.uk](http://www.buzzybees2000.co.uk)

**JOHN E S JONES**

**GENERAL  
BUILDER**



Carpentry, painting and  
decorating, extensions, uPVC,  
facias and gutters, fencing,  
decking and patios

**Also general repairs**

Telephone 01373 832600

Mobile 07074 832600



## Simple guide to building the perfect...

# Nesting box

If you have a plank of wood and a spare half an hour here's a simple bird box design.

- Nest boxes should be made from wood, Metal and plastic are unsuitable materials as they may cause the contents of the nest to overheat or allow condensation to build up inside the box, wetting eggs and chicks.
- The type of wood used is not critical but hardwoods, such as oak and beech, will outlive soft wood, such as pine.
- Rather more critical is the thickness of the wood, which should be at least 15mm to provide sufficient insulation and to prevent warping.
- It is better to nail your box together rather than gluing it (remember to use galvanized/stainless steel nails to stop rust) as this allows water to drain.
- Make sure you drill a couple of holes in the base of your box to ensure that any rain that does get in can drain out quickly.
- Do not put a perch on the front of the nest box as this is not necessary and may aid access to a predator!

## Hole sizes

Different size holes are suitable for different species:

- 25mm or larger for Blue, Coal and Marsh Tit;
- 28mm or larger for Great Tit and Tree Sparrow;
- 32mm for House Sparrow.

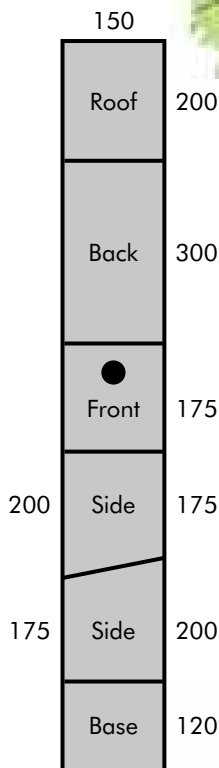

Plank size:  
150mm x 1170mm

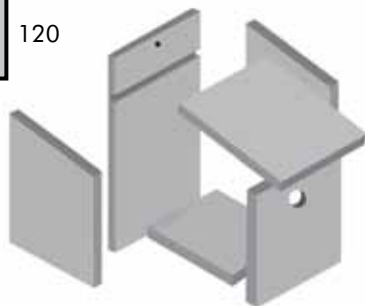

Rob White  
Acres Supply Garden Centre, Corsley

# TEA & sympathy

Considerate catering at a difficult time

*Catering specifically for funerals.*

*All our food is homemade, therefore, should you have a special request, perhaps a favourite cake ~ just ask and we will do our best.*



Telephone Kim Clark on 01373 832151 or 07843 056916

e-mail [tea.sympathy@hotmail.co.uk](mailto:tea.sympathy@hotmail.co.uk)

[www.teaandsympathy.uk.com](http://www.teaandsympathy.uk.com)

## CHANTRY CONSTRUCTION

stone walling • patios

drives • extensions

*prompt reliable service*

*mini digger and driver for hire*

**01373 836787      07855 343388**

COMPUTER & LAPTOP REPAIRS  
UPGRADES / SYSTEMS & LAPTOPS

VIRUS REMOVAL / BROADBAND

WIRELESS / NETWORKING



FAST, FRIENDLY, PROFESSIONAL SERVICE  
COMPETITIVE RATES  
ONSITE OR WORKSHOP

pcie CompTIA  
A+ Certified

call  
**01373 302901**

[www.ntscomputing.co.uk](http://www.ntscomputing.co.uk)

[help@ntscomputing.co.uk](mailto:help@ntscomputing.co.uk)

### LAPTOP REPAIRS

We also replace  
laptop screens,  
keyboards,  
CD-DVD drives,  
fix overheating  
and more

## Forget-me-not

• GARDENING SERVICE •

 Weeding, pruning, planting,  
fence painting, etc

01373 464416

07890 850465

## Do you need a plumber? Call...



## Paul Antell Plumbing

07890 366832

01373 467427

Professional, reliable, friendly and local

[paulantellplumbing@talktalk.net](mailto:paulantellplumbing@talktalk.net)

[www.paulantellplumbing.co.uk](http://www.paulantellplumbing.co.uk)

## Weatherproof Windows Co.

- Renovation
- Replacement
- Draught-proofing
- Small repairs
- Replacement cords, pulleys handles, weights, glazing

All types of sash and wooden windows  
suitable for Listed Buildings

Ian Gallagher

Fleecemill Cottage, 1 The Steps,  
Buckland Dinham, BA11 2QR

Tel: 01373 474637 Mobile: 07929 938419

[www.weatherproofwindows.co.uk](http://www.weatherproofwindows.co.uk)

## EVERGREEN GARDEN SERVICES

Garden maintenance and landscaping,  
lawns, strimming, hedging, pruning  
long and short term maintenance,  
patios fencing, turf and seeding.

Over 20 years experience in  
horticulture, landscaping and estate  
management.

**Contact Ben Hale**

01373 825495

07879 492283



## Rose Knight

House sitting and  
dog and cat minding  
service

01373 464904

07773 435254

[knight\\_rosemary@sky.com](mailto:knight_rosemary@sky.com)



*Tree Tops  
Catering*



Contact Sharon Marie on 07941 383883

*Specialised mobile catering  
to suit your event*

## ROGER PATCH GENERAL BUILDERS

**Now offering purpose-made joinery**

We can now offer a purpose-made joinery service to  
complement our general building business

Please ring us for quotations on windows, doors, stairs, etc.

Cedar Cottage, Wolverton, Zeals, Wiltshire, BA12 6LW

**Telephone 01747 840449 Mobile 07971 686973**

**Chapmanslade Parish Council**

# Parish Council Briefing

Phil Jefferson reports on the January meeting and on other parish matters

## Planning

We looked at two planning applications at our January meeting. We raised no objection to an application to build a garage and home office with storage in the garden of 140 High Street. We did, however, object to an application to extend the barn currently under construction at Sienna Valley in Huntenhull Lane as we consider that the proposed building is too large. We also have concerns about the impact of the building on a sensitive landscape and about the dangers created by increased traffic. We have asked Fleur de Rhe-Philipe, our Wiltshire Councillor, to "call in" the application, so that it can be dealt with by Wiltshire Council's Planning Sub-Committee. It now appears that the barn currently being constructed may be on the wrong "footprint", which could delay the planning process.

## Highways

Wiltshire Highways tell us that they will deal with the flooding problems outside the old Rectory and at the Dead Maids slip-road and that they will resurface Southcroft. However, the recent bad weather has had a dire effect on so many of our roads, not just in the parish but across the whole county, so we have been asked to be patient! Even so, at the time of writing this, we have just

learned that the council have filled in some of the potholes in Wood Lane. In response to a request by some residents of Wood Lane, we have asked Wiltshire Council to improve visibility at the junction with the High Street by painting a white line on a short section of the road adjacent to Wheelwright's. We hope to see this soon.

We send Wiltshire a monthly report on highway maintenance issues, so please report any new problems you notice to Keith Muston at [themustons@btinternet.com](mailto:themustons@btinternet.com) or on 01373 832755.

## Footpaths

Wiltshire Council has completed its inspection of our network of public footpaths and has already sorted out some of the problems that were found. We are hoping to help with some of the work required on the paths, and we are looking for volunteers who may be able to help. If you have some spare time at the weekends, or if you know of any issues or problems with any of the paths, please contact Adam Oakley at [adam@oakleyfrome.co.uk](mailto:adam@oakleyfrome.co.uk) or on 832437.

## Mains Gas

Following the discussion at our November meeting, Kerry Jones reported on the present position. A reasonable number of

residents have expressed an interest in being connected to mains gas but the target of 59 properties hasn't been reached yet. If you haven't contacted Kerry yet, or have a question you would like to ask him, please contact him at [kns gasandheating@gmail.com](mailto:kns gasandheating@gmail.com) or by phoning him on 07733 260512. We intend to produce a flyer giving further details of the proposals, which in due course will be distributed to every property in the parish.

## **Transport to Kingdown School**

Davina Lawrence, a village resident and parent of a pupil attending Kingdown School in Warminster, came to the meeting to alert us to problems concerning school transport. Beeline, the local coach operator, has withdrawn one of its services, leaving parents in some difficulty, including financially. As Matravers School in Westbury is the designated secondary school for Chapmanslade, Wiltshire Council is extremely limited in any support it can give to parents choosing to send their children to Kingdown. Davina has recently received a response from Wiltshire Council so, if you are a Kingdown parent or hope to be by next September, please contact her at [davinalawrence@blueyonder.co.uk](mailto:davinalawrence@blueyonder.co.uk) for the latest information. Davina will come back to the parish council later if she still needs our help.

## **Precept**

This is the time of year when councils announce how much money they intend to raise through the council tax. For 2013/14 we were pleased to be able to reduce the precept (the amount the parish council levies in council tax) but this year there will be a very small increase. This is due to a reduction in the grant we receive from Wiltshire Council, which itself will be getting

a smaller grant from central government. The parish council's precept for 2014/15 will be £3,861.81, which will be added to the grant of £149.99 we will receive from Wiltshire and represents an increase of just under 3%. For band D taxpayers this means they will pay just under £13 in 2014/15, an increase of about 13p. Most of our precept is spent on supporting our village hall and we hope that the parish council gives value for money.

## **Thoulstone Park**

The owners of Thoulstone Park have asked us to help publicise a tree planting weekend on the 15th and 16th February, from 10 am until 3.00 pm each day. So far, working with the Forestry Commission and The Woodland Trust, they have planted 26,000 trees covering 51 acres and the aim is to complete the task at the volunteer weekend. Anyone wishing to volunteer their help is asked to contact the owners at [info@thoulstonepark.co.uk](mailto:info@thoulstonepark.co.uk). Details of the owners' aspirations for Thoulstone are on their website at [www.thoulstonepark.co.uk](http://www.thoulstonepark.co.uk)

## **Coffee Morning**

A reminder that the community coffee morning is held on the third Thursday of each month at the Three Horseshoes, from 10 am until noon. The coffee morning is becoming increasingly popular, and now has an attendance of up to thirty. So, if you fancy a great cup of coffee and a friendly chat, do come along on the 20th February. I can also mention that there are moves afoot for a Senior Citizens' afternoon tea and perhaps even regular Senior Citizens' lunches, so keep in touch via The Bridge or the village website at [www.chapmanslade.org.uk](http://www.chapmanslade.org.uk)

## **New Year's Honours**

Finally, at our meeting we were delighted

to be able to congratulate Professor Nigel Brown, a village resident, on being awarded the OBE in the New Year's Honours List, in recognition of his services to science. Nigel is Emeritus Professor of Molecular Microbiology at Edinburgh University and President of the Society for General Microbiology. We are very pleased that he

and Gayle chose to move to Chapmanslade on his retirement and we offer him our very best wishes.

Phil Jefferson  
phil.jefferson@virgin.net  
01373 832845

[www.chapmanslade.org.uk](http://www.chapmanslade.org.uk)



## News from the Nest

Welcome to this month's feature of 'News from the Nest' from Little Cuckoo's Pre-School in Lyes Green, Corsley.

After a wonderful Christmas break, Little Cuckoos are enjoying the start of this new year with this term's topic - the weather; our great British weather offers such a variety of weather so there's plenty to learn about!

Our Tuesday Mother and Toddler group has re-launched and runs every Tuesday term-time morning between 10am and 11.30am at Little Cuckoos. Parents/carers can enjoy a variety of arts and crafts, singing or playing whilst getting to meet new friends. Just bring a piece of fruit to share and pay a nominal charge.

We are hoping to re-launch the Little Cuckoos book shop to help raise funds for the pre-school and would be delighted with any donation of good quality unwanted childrens' books. Call Denise on 01985 300853 for further info.

We have lots of exciting events planned over the next few months, starting with several 'stay and play' sessions for the children and their families, and our very successful storytelling evening - complete with onesies and hot chocolate!

Opening hours: Monday, Wednesday, Thursday and Friday 9am - 3pm

Mother and toddler group: Tuesday 10am - 11.30am

For more information, please contact Hayley on 01373 832298

[www.littlecuckoos@hotmail.co.uk](mailto:www.littlecuckoos@hotmail.co.uk)

# Barn Dance



7.30pm, Saturday 8th March  
Chapmanslade Village Hall

Tickets £12 adults, £6 children  
to include a 2 course supper  
from Denise Page 01373 832485

## CHAPMANSLADE VILLAGE HALL FLOOR

Chapmanslade Village Hall Committee are trying to raise a considerable sum of money to replace the hall floor. We already have a grant of £5,000, but still need to raise many thousands! We are proposing to run a Grand Raffle: 1st Prize £100 Amazon vouchers, 2nd prize £75 Amazon vouchers and 3rd prize £50 voucher for a meal at

The Three Horseshoes, plus other prizes. This will be drawn at the Village Barn Dance on 8th March. We shall be trying to deliver some raffle books to every household, and would appreciate if you would consider purchasing at least a small amount. We realise the economic climate is not good at the moment, but every little helps!

## Richard Dean's School Report

# Bloodshed in South Sudan

*'God is our refuge and strength, an ever present help in trouble'*

*Psalm 46, verse 1*

Fighting between rival factions in the South Sudan Army erupted overnight on 15th December 2013 in an attempted coup. Over the next 3 days fighting continued in and around Juba and a large number of people were killed or wounded. The main hospital, which has 130 beds, had 1,000 in-patients. Though the trouble was sparked because of a political power struggle it had tribal implications and violence between the Dinka tribe and Nuer tribe resulted. At Juba Diocesan Model Secondary School (JDMSS), there are students from most of the tribes and this tribal mix has always been regarded as a great advantage in breaking down barriers through long-term friendships being formed.

The fighting in Juba stopped after three days but has continued in areas of the country where the Dinka and Nuer tribes 'overlap'.

It is estimated that over 1,000 have been killed, 50,000 have fled the country, and some 350,000 people have been internally displaced, seeking shelter in UN compounds and other refuges. There were initially some 3,000 in All Saints Cathedral compound in Juba, and the Primary School compound next to JDMSS was also occupied. The grounds of JDMSS itself are well protected by fencing and were not occupied. Most ex-patriots have left the country, including Kenyans and Ugandans. A few have courageously stayed put, including two friends of the school, Joseph Bilal and Charlie Goldsmith.

### How does this affect the school?

The school closed for the final few days of term after the fighting started. As far as we know none of our students have been killed







or wounded, but the ongoing presence of both Dinka and Nuer students in the school will require much grace.

The school re-opened on Monday 6th January; only 249 students arrived out of 520 on the school roll and initially only half the teachers were present. Now, two weeks later, the number of students has risen to 450. There are still some teachers missing. The end-of-year exams have started for Years 1 and 2 and those teachers in school will have to cope with all the invigilation and marking. Students in Year 3, the final year, are revising hard for their School Certificate exams due in February but with all the disruption there must be a question mark as to whether the papers will be set in time.

### Encouragement

Charlie Goldsmith has written: "I was delighted to see that JDMSS pupils were going to and from school as normal, and as well turned out as ever". It is so encouraging

to hear this. As petrol is now a 'black market' commodity there are very few cars on the road and no public transport. The students are walking to school which for some is 6 miles from where they live. This just shows how keen they are for education!

Whilst there is yet to be a cease fire between the rival factions and fighting is still going on in large areas North of Juba, (where all the schools will be closed), there are signs of normality in Juba itself. The banks are open and we have been able to send out £800 to provide bonuses for the teachers and staff. Providing that the situation does not deteriorate I am still planning to go out to Juba in July.

We give thanks to God that the school is now functioning more or less normally. But in the midst of all the acute suffering in the country we ask God to be an 'ever present help', and to make the school a beacon of hope for the future.

*Richard Dean*

## Steve Dayman-Johns

### Driving Instructor

Condensed Courses and  
Gift Vouchers available

Tel 01373 865422 - Mob 07730 445648

email [stevekdj@gmail.com](mailto:stevekdj@gmail.com)



## zia pizza

pizzeria restaurant • italian take away

ANDREA & VIC INVITE YOU  
TO SAMPLE AN AUTHENTIC ITALIAN  
DINING EXPERIENCE. FROM PASTA  
TO TRADITIONAL STONE BAKED  
PIZZA, AVAILABLE IN THE  
RESTAURANT & TO TAKE AWAY -  
DELIVERY SERVICE AVAILABLE

[www.ziapizza.co.uk](http://www.ziapizza.co.uk)

**t: 01373 865271**

15 palomino place • westbury  
wiltshire • ba13 3sd

## Dashing Dusters

- Cleaning and ironing to a high standard
- General domestic assistance
- Commercial cleaning
- Reliable
- Reasonable rates
- References available

01373 832484 (evenings)

## M W Garden Services

20+ years experience

A tailor made service for all  
types of garden maintenance

Insured and CBI's checked

[mark22.weaver@mypostoffice.co.uk](mailto:mark22.weaver@mypostoffice.co.uk)

Telephone 01373 832854

Mobile 07883 025475

## Black Dog Farm

### Bed & Breakfast

You will find a friendly welcome and a hearty  
breakfast in our listed Georgian Farmhouse.  
The quality en-suite bedrooms contain everything  
you need to ensure a comfortable stay.

Lyn and Fraser Mills ~ 01373 832858 or 07878 954563  
Black Dog Farm, Chapmanslade, Westbury, Wilts, BA13 4AE  
[www.blackdogfarm.co.uk](http://www.blackdogfarm.co.uk)



## Hardwood logs for sale

(cut to size if required)

**FREE DELIVERY**

## R M Log Supplies

Beckington

Call Robin on

**07876 621929**

## Office to let – Corsley

One 250 sq ft room  
left. Historic country  
house setting.  
Excellent working  
environment.

Call 01373 832120



# Whitbourne Chapel

## February preachers:

2nd	Reverend K Sobey, retired Baptist Minister
9th	Mr P Stinchcombe, Frome solicitor
16th, 23rd, 30th	Services led by the Chapel's own preachers

## Spring IS on its way!

The Reverend Keith Sobey led morning service on 29th December. Afterwards, he noticed a primrose plant in full flower. "Primrose Day isn't until April 19th!" he exclaimed. Primrose Day? I didn't know there was such a thing!

In my dog-walking days, I found primroses flowered later than snowdrops, but I haven't spotted any snowdrops yet. Have you?

At the time of writing – 3rd January – we've had mostly mild weather. I use the word 'mostly' because we had a hail storm this morning, with thunder and lightning! An hour later, though, I was driving along roads, dazzled by the sunshine, wearing my sunglasses!

## Spring is on its way; new life is coming.

Whatever weather we get, if we're patient, it changes. Imagine if we had twelve months of constant rain, of constant heat or cold, or constant sunshine. What's wonderful about England is that the weather DOES change! Bulbs emerging from the soil – daffodil shoots are three inches tall in the Chapel's flower bed – show us Spring, new life, IS on the way.

Many years ago, God promised: "While the earth remains, seedtime and harvest, cold and heat, summer and winter, day and night shall not cease."

## Descriptions of Jesus

**Creator** "God has in these last days spoken to us by His Son, whom He has appointed heir of all things, through whom also He made the worlds." *Hebrews 1:2*

## Bible Quiz – three new things

- 1 What are new every morning?  
*Lamentations 3. 22-23*
- 2 Jesus gave this new thing to the disciples after He had washed their feet. *John 13.34*
- 3 What new things did John, in exile on the Isle of Patmos, see in a vision?  
*Revelation 21.1*

## To ponder

In Germany, during the Second World War, Jews in hiding left this inscription on a cellar wall: "I believe in the sun even when it is not shining. I believe in love even when feeling it not. I believe in God even when He is silent."

*Gill Redman 01373 832573  
paradiselost@btinternet.com*

## Regular times

**Every Sunday** morning at 11.00 for about an hour (coffee served at 10.45)  
**Communion** on the first Sunday of each month at 12 noon for 15 minutes.  
**Favourite hymns** + tea party every third Sunday in the month at 5 to 6.30  
**House-group Bible** study every Tuesday at 7.30



# COMPUTER PROBLEMS?

**01373 812804**

Email  
Advice for new users  
Anti-virus defence  
Web sites  
Custom programming

Networks - home & office  
Home tuition  
Web access  
Privacy & security  
Repairs

[www.technojeeves.com](http://www.technojeeves.com)

[info@technojeeves.com](mailto:info@technojeeves.com)

No Job Too Small



**Local Electrician**

Part "P" registered NAPIT approved  
Domestic and Commercial Work Undertaken  
Third Party Testing

Call for a Free no obligation Quotation

Tel: 01749 850769

Mobile: 07779 429786

email:

[iain@fushi-electrical.co.uk](mailto:iain@fushi-electrical.co.uk)

[www.fushi-electrical.co.uk](http://www.fushi-electrical.co.uk)



## E G MARTIN LTD Heating Oil Distributors

Telephone 01373 822784

Victory Road, West Wiltshire Trading Estate  
Westbury, Wiltshire, BA13 4JL

## WESTERN SKIP HIRE

Telephone 01373 865247

Victory Road, West Wiltshire Trading Estate  
Westbury, Wiltshire, BA13 4JL



## Hassle-free quotes No 'sales patter'!

- **ENERGY RATED** windows - reduce your heating bills
- **NEW SECURITY** windows with Shootbolt locking
- **EXPERT FITTING** by our own fully trained team
- **REPUTATION** - Over 25 Years of satisfied customers

## Come & visit our Indoor Show Village

See our full range of Windows, Doors  
Conservatories & roofline items  
at Woodcock Industrial Estate, Warminster

Tel 01985 215566  [www.NewWindowsLtd.co.uk](http://www.NewWindowsLtd.co.uk)

**newWINDOWS**



# Tales from the passenger seat

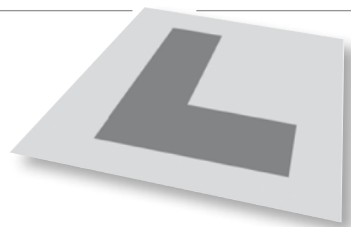

The week before Christmas I had two pupils take and pass their test. One of them, Mrs Tryhard really deserved to pass: the other, Mr Barestminimum did pass, but should he have?

Mrs Tryhard was a lady of 71 who, although she initially found the physical side of driving a car very hard, her determination to master the car control skills eventually got her to the point where we could start to get more into reading the road, and working out what was happening outside the car, rather than what was happening inside the car. Naturally she took more lessons than a younger person, and although age can statistically be a reason why on average a younger person may take fewer lessons, there are plenty of older people who have learned in fewer lessons than some 17 year-olds.

However, Mrs Tryhard had to get considerably better than the younger person, because if ( in general ) a young person makes a mistake, their reflexes allow them to correct the error quickly and carry on as though nothing had happened. They may gain a minor fault, but it's not a fail if put right promptly and calmly. The older person may make the same mistake, but take so long to realise, and then to correct it, that far too long has passed, and it is a fail. Therefore the older person's standard often needs to exceed the younger person's simply so that they don't make the mistake in the first place.

Mr Barestminimum was 17, perfectly capable of controlling the car and correcting mistakes but because he did not have to try hard to drive, he couldn't be bothered to try at all. He was constantly asking me, when he made a mistake ' Would that have failed me?' Essentially if I said 'No', then he was OK with that and didn't care if he did it again... Foolish, since although minor faults may not individually constitute a fail, too many of the same type of mistake (often 3) does make for a fail. So I had to really impress upon him the need for maintaining a standard and not being sloppy simply because he found controlling a car quite easy.

What finally worked was when I compared him to Mrs Tryhard, and said that although he was naturally twice as good as her, she was probably going to pass, and he was likely to fail. I suggested to him that if his standard was say '20' on a scale, and hers was say '10', that if she tried really hard and came up to a '15', and he remained sloppy and dropped to '15', then effectively he was no better than a 71 year old novice driver. He didn't like that thought (no surprises there)! But it did the trick. From then on we had wonderful concentration and effort, because in his mind he was competing against my older pupil, and there was no way he was going to fail and learn that she had passed.

As I've said before, I am 50% a psychologist, and 50% a driving instructor. But it works.

*Steve Dayman-Johns*

## **Corsley Reading Rooms**

Attractive function hall, smaller meeting room and kitchen facilities all available for hire

Parties • clubs • meetings • classes • etc

*Contact Rosemary Collins for details*

**01373 832789**

## **NEED HELP WITH YOUR GARDEN?**

Hedge cutting • Lawn mowing  
Strimming • General gardening

**Call Rob Clements**

**Tel 01373 832683 Mob 07586 337118**

## *Wren House*

**Residence for the retired and elderly**

We offer a range of care and accommodation to cater for the varying needs of retired and elderly people, either in the full care of Wren House, or assisted living in our two Coach House flats. Alternatively, more able and independent elderly people may choose to purchase an Orchard Retirement Apartment, with the assurance of care facilities close at hand.

**Mrs Ellie Simmonds - Manager**

Wren House, 32 Vicarage Street, Warminster, BA12 8JF

Telephone 01985 212578

## **Bluebell Interiors**

**Bespoke Kitchens  
and Fitted Furniture**

**27 High Street, Warminster,  
Wiltshire, BA12 9AG**

Telephone  
**01985 988192**

Email  
**sales@bluebellkitchens.co.uk**

*Free Quotation Without Obligation*

## **the old Blue House**

Small, friendly B&B with a twin and double room  
and off street parking

Call Liz on 01373 300759

103 High Street, Chapmanslade, BA13 4AN

[www.tholdbluehouse.co.uk](http://www.tholdbluehouse.co.uk)

## **Paul Ledbury Quality Painting and Decorating**

**30 years experience**

**INTERIOR AND EXTERIOR  
GENERAL MAINTENANCE**

**5 Hampshire Gardens  
Westbury, Wiltshire  
BA13 3EX**

**Telephone 01373 858163  
Mobile 07976 252045**

# NSM BUILDING & ROOFING

For all your plumbing roofing and general building requirements

**Contact Nick Madelin**

Tel: 01380 830 370

Mobile: 07766 102 034

Over 25 years experience

Credits in City & Guilds

# PILATES

**Small group classes  
and 1:1 tuition**

Improve your posture and mobility

Lengthen, strengthen and tone

Rehabilitate after injury

Classes in Warminster and  
Horningsham

**www.hhpilates.com**

**Call Caroline on 07734 904193**



# DAVID NOBLE

**APPROVED ELECTRICAL CONTRACTOR**

- Complete installations
- Minor works/repairs
- Testing
- Intruder alarms
- Lighting design



5 Swaledale Road  
Warminster, Wiltshire  
BA12 8FH

Tel 01985 214630  
Mobile 07970 618232  
dcnoble@btinternet.com

# Allsorts of Fencing

*Peter Allsop*

[allsortsoffencing.co.uk](http://allsortsoffencing.co.uk)

All types of domestic and agricultural  
fencing supplied and erected

Also:

- Decking and patios
- Sheds, pergolas and archways
- Topping of fields and paddocks

[Allsorts-of-fencing@hotmail.co.uk](mailto:Allsorts-of-fencing@hotmail.co.uk)

**01373 832339**

**07710 180551**



# KB Landscape

30 years in landscaping

Phone

**01373 832371**

Mobile

**07951 297173**

**Kevin Brixey - for quality and experience**

5 Red Cottages Corsley Warminster Wiltshire BA12 7PS

Landscaping  
Patios and paths  
Turfing and seeding  
Brick and stone walling  
Decking and pergolas  
Block paving  
Gravel drives  
Pond work  
Fencing



**A view from over the hedge...**

# Countryside Matters

February is our shortest month in terms of days, but thankfully the daylight hours are getting longer...

The pheasant and duck shooting both finished at the end of January for another season: they have to do now is to avoid being run over on the roads, or eaten by foxes. Even when introduced specifically for shooting those birds which survive the winter will go on to breed in the woods and hedges and on our ponds.

The big topic of conversation, even more than normally, has been the weather. Here in West Wiltshire we have avoided the worst of the floods, but many have not. Fortunately deaths have been few, but there has been much damage to property, and disruption to so many peoples' lives.

Farming is likewise affected by flooding, although not all winter floods have a negative effect. Fields used to be flooded briefly on purpose; this allowed the fertile silt from upriver to be deposited on the low-lying fields, which would then be grazed in spring, or mown for hay later in summer. However, if the floodwaters stay for too long all the invertebrate life (especially those vital earthworms) dies and the soil becomes 'sour'; its use for agriculture is then greatly diminished. Those farmers whose land has been underwater for several weeks now will be in desperate straits with nowhere to graze their beasts and few means of growing any fodder.

The accompanying gales have taken their toll on a number of mature trees; many oak, ash, beech, and willow have fallen or been broken by the winds. Ash and beech are particularly susceptible, being shallow-rooted – the wet ground increases the chances of trees being uprooted.

Much more cheerfully, the snowdrops should be in flower this month. There will be hazel and pussy willow shedding catkins pollen on warmer days. The woods, hedgerows and verges will start to green-up; Dog's Mercury will start flowering along with the Blackthorn. Perhaps the daffodils won't be too far behind!

Please do keep putting out food and water for your garden birds. Our winter visitors, such as Redwing and Fieldfare, need to fatten up for their long trek north to their breeding grounds, whilst those who stay need to be in peak condition for breeding as soon as the weather warms. Sunflower seed and peanuts will attract the finches and tits, thrushes will love apples, and fat products will feed a whole range of small birds.

Enjoy watching them, and being in our lovely countryside.

*Judith Helliar*





# One day at a time

**Caroline Le Vine, Counsellor in Corsley**

We're well into the New Year now and, for some people, this focuses the

mind onto cheerful possibilities held by the future. For others, though, the future is a dreary grey path stretching out unendingly beyond them or a continuation of already unbearable feelings. So great is their pain that they cannot imagine a life without it.

I know people who have found it useful to try and bring their focus back towards the present. In this way, you can deal the issue and feelings you face in smaller, more manageable chunks. You look at what you are going to do in the immediate future and how you feel right now, avoiding the temptation to look too far ahead because, for now, you cannot deal with too much all in one go. Sometimes, one day at a time is too much to contemplate – if this is the case, reduce the time; down to a half day, an hour or even right down to one minute at a time if you need to. Then you decide how you are going to get through that period. Maybe you'll make a list of activities so that you're structuring the time; maybe you'll go for a walk or ring a friend. You don't have to tackle the problem headlong. You can choose to just get through this day, hour or minute.

Of course, you won't want to spend the rest of your life using this method of survival. If your struggle continues you might want to consider outside help – see your GP, find a suitable support group or try counselling.

If you need some help with an enduring difficulty or a safe place in which to talk in confidence and without judgement, come and see me: I practice at St Margaret's Church, Deep Lane, Corsley. A first half hour meeting with me is free of charge.

[www.carolinelevine.co.uk](http://www.carolinelevine.co.uk)  
07817 192008  
[le\\_vine@sky.com](mailto:le_vine@sky.com)



The new fun  
dance fitness class  
created by 'Strictly  
Come Dancing'  
professionals and  
based on Ballroom and Latin  
dance moves

**Chapmanslade Village Hall**  
**Thursdays 7-8pm**

**£4 per class**

**Odele Blyth**  
**t. 07860 472894**  
**Facebook. Odele Blyth Dance**



# Small ads

£1 for EACH item for sale or wanted (cash only please) - at one of the two drop-off locations)

**Please note: no cash, no advert!**

## FOR SALE

### LED TV/DVD Combi - 16" Super Slim Cello

12v or mains operation, suitable for caravan, motorhome or bedroom. Integrated digital Freeview and suitable for satellite receiver. USB socket (recordable), remote control, wall mountable or table stand (not included). Perfect working order used last 18 months - **£90 ono**  
**01373 832375**

## FOR SALE

One painted, white **cot** with nearly new mattress. Ideal for grandchild visiting! **£10**  
**01373 832485**

### **The mobile library service visits next on:**

**Thursday 6th February**

10:10 - 10:30

Corsley, by the Royal Oak pub

10:45 - 11:00

Chapmanslade, outside 132 High St

11:05 - 12:00

Chapmanslade, by the school

Future dates for this round are:

**20th February, 6th and 20th March**

### **Answers to Bob's Bafflers**

- 1 Berkshire
- 2 Robin Hood
- 3 Oliver – surprisingly George was just number 13 on the list
- 4 Troposphere
- 5 Westminster Abbey
- 6 Massachusetts
- 7 Hooves
- 8 Sophia Loren
- 9 Carbon dioxide
- 10 Ian Fleming
- 11 True Grit
- 12 A lucifer

## **Local organisation adverts**

£2.00 per month for a small boxed advert. All monies must be at one of the two drop-off locations (Barbers Plant Centre or Acres Supply Garden Centre) by 4pm on the 19th of the month. Please note: no cash, no advert!

## **Trade advertising**

Annual trade advertisements (12 issues, when space is available)

1 space	(69mm wide x 33mm high)	£22.00
2 spaces	(69mm wide x 66mm high)	£42.00
3 spaces	(quarter page - 69mm wide x 100mm high)	£60.00
4 spaces	(138mm wide x 66mm high)	£75.00
6 spaces	(half page - 138mm wide x 100mm high)	£104.00

Trade advertisement material should be supplied in print-ready format, to the chosen standard size and correct shape.

For trade advertising enquiries, please contact David James (Trade advert coordinator/  
Treasurer) at either thebridge832@gmail.com or 01373 832443.



## Garden Machinery Specialist

Authorised Dealer

**HONDA**

**STIHL**

**SALES • SERVICE • PARTS**



## Professional Tree Surgeons

- Tree pruning
- Felling
- Hedge trimming
- Barn-dried logs

**Andy Brake**

**01373 832965**

Green Farm Ind Est, Chapmanslade Westbury BA13 4AN

**01373 830429**

[www.newlandstrecare.co.uk](http://www.newlandstrecare.co.uk)



## Frome Heating Specialists

**M A Knight**

**01373 832578**

**Heating and plumbing engineers specialising in:**

Solar heating

Oil and gas boiler servicing

Boiler replacement

Energy management

Pressurised hot water systems

Underfloor heating systems



Reg. 199876



Reg. C1211

Family business established 1964

Stavanger, Corsley, Nr Warminster, Wiltshire, BA12 7QL

# Acres Supply

For all your gardening and aquatic needs



Bay Tree Farm · Corsley · Wiltshire · BA12 7PP · 01373 832591 · [acresupply.com](http://acresupply.com)

## John White Landscape

Providing an all-round design and landscaping service

*A family business established in 1970*



A trading name of The Midcounties Co-operative

YOUR LOCAL INDEPENDENT TRAVEL AGENT AND CRUISE CENTRE

**MASSIVE CHOICE! GREAT VALUE!**

**FROME**

**01373 462600**

1 CHEAP STREET, FROME BA11 1BN  
OPEN MON - FRI 9.00-5.30, SAT 9.00-5.00

[sales.frome@travelangels.net](mailto:sales.frome@travelangels.net)

**WARMINSTER**

**01985 211733**

70 MARKET PLACE, WARMINSTER BA12 9AW  
OPEN MON - FRI 9.00-5.30, SAT 9.00-5.00  
[sales.warminster@travelangels.net](mailto:sales.warminster@travelangels.net)



**[www.travelangels.net](http://www.travelangels.net)**

Agents for ATOL holders

